

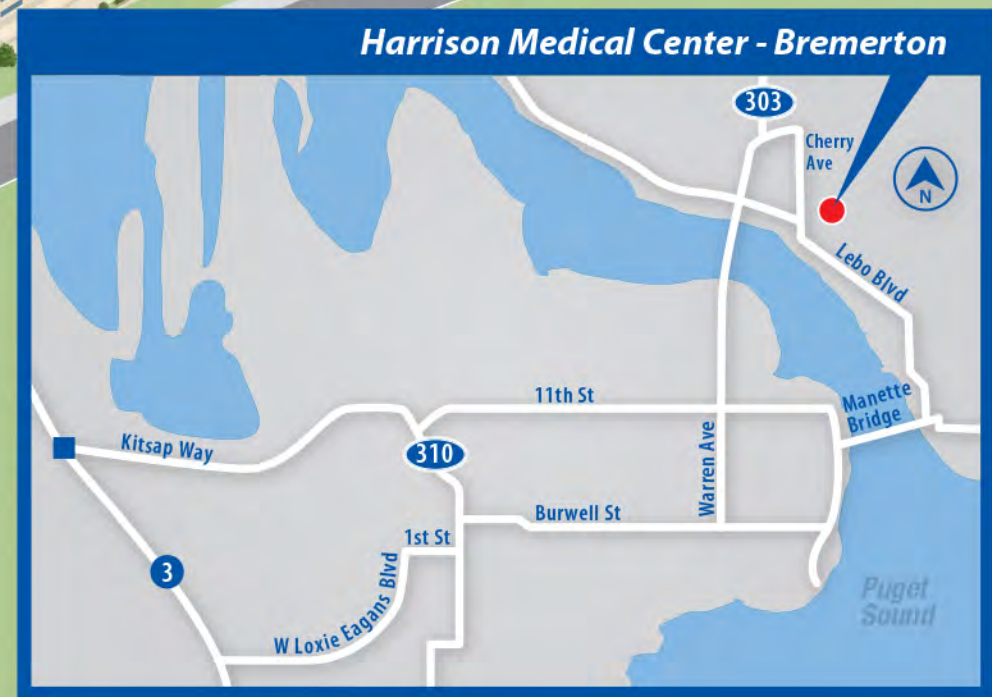

Harrison Medical Center

BREMERTON

Visitor Guide

2520 Cherry Avenue
Bremerton, WA 98310
(360) 744-3911



Scent- and Smoke-Free Environment 
Harrison Medical Center is a scent-free and tobacco/nicotine-free campus. No cigarettes are allowed, including e-cigarettes.

is located in room _____
on floor _____

Legend

- Information & Reception
- Elevators
- Stairs
- Restrooms
- Waiting Area
- Dining
- Garden
- Nurses Station
- Medical Imaging
- Laboratory
- Cashier
- Patient Rooms
- ATM
- Health Information Management/ Medical Records

- Zone Perimeter
- Public Corridor
- Staff Corridor

- Elevators**
- Elevator A serves floors G, 1, 2, 3, 4
 - Elevator B serves floors 1, 2, 3
 - Elevator D serves floors G, 1, 2
 - Elevator E serves floor G



Scent- and Smoke-Free Environment

Harrison Medical Center is a scent-free and tobacco/nicotine-free campus. No cigarettes are allowed, including e-cigarettes.

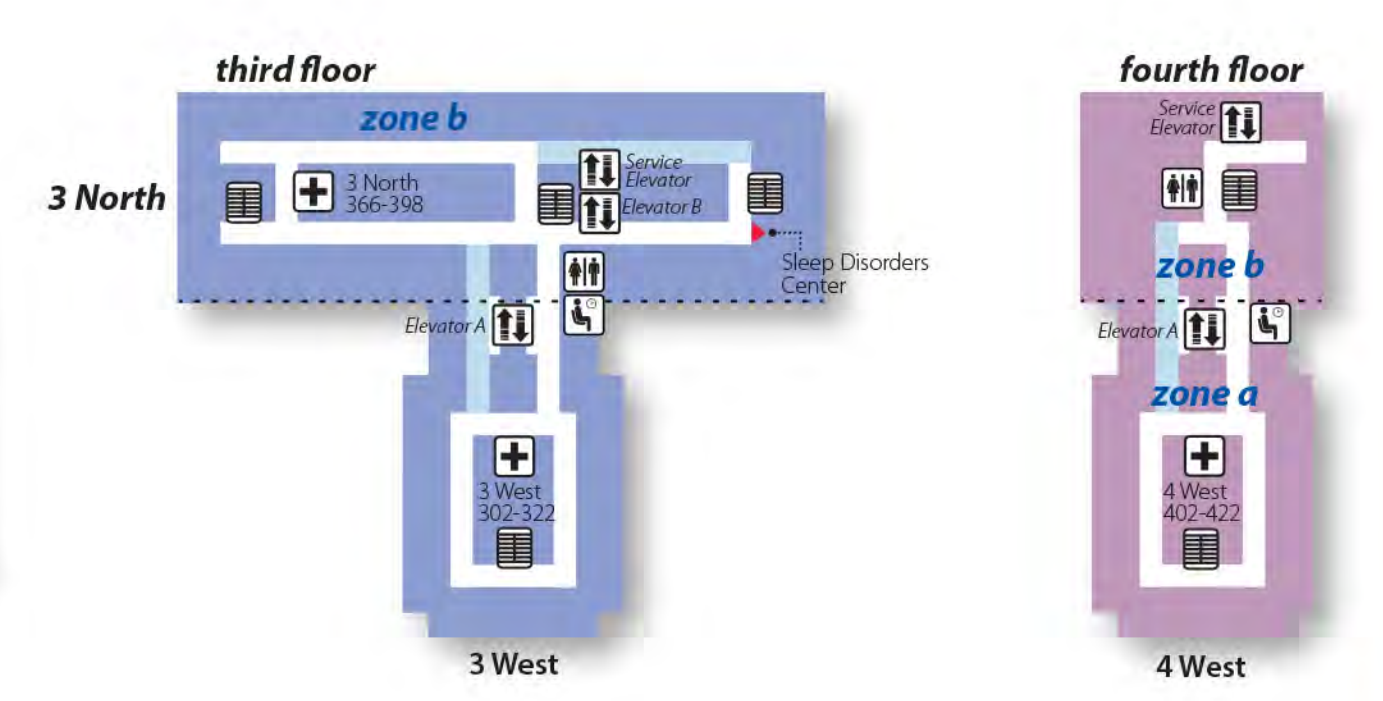
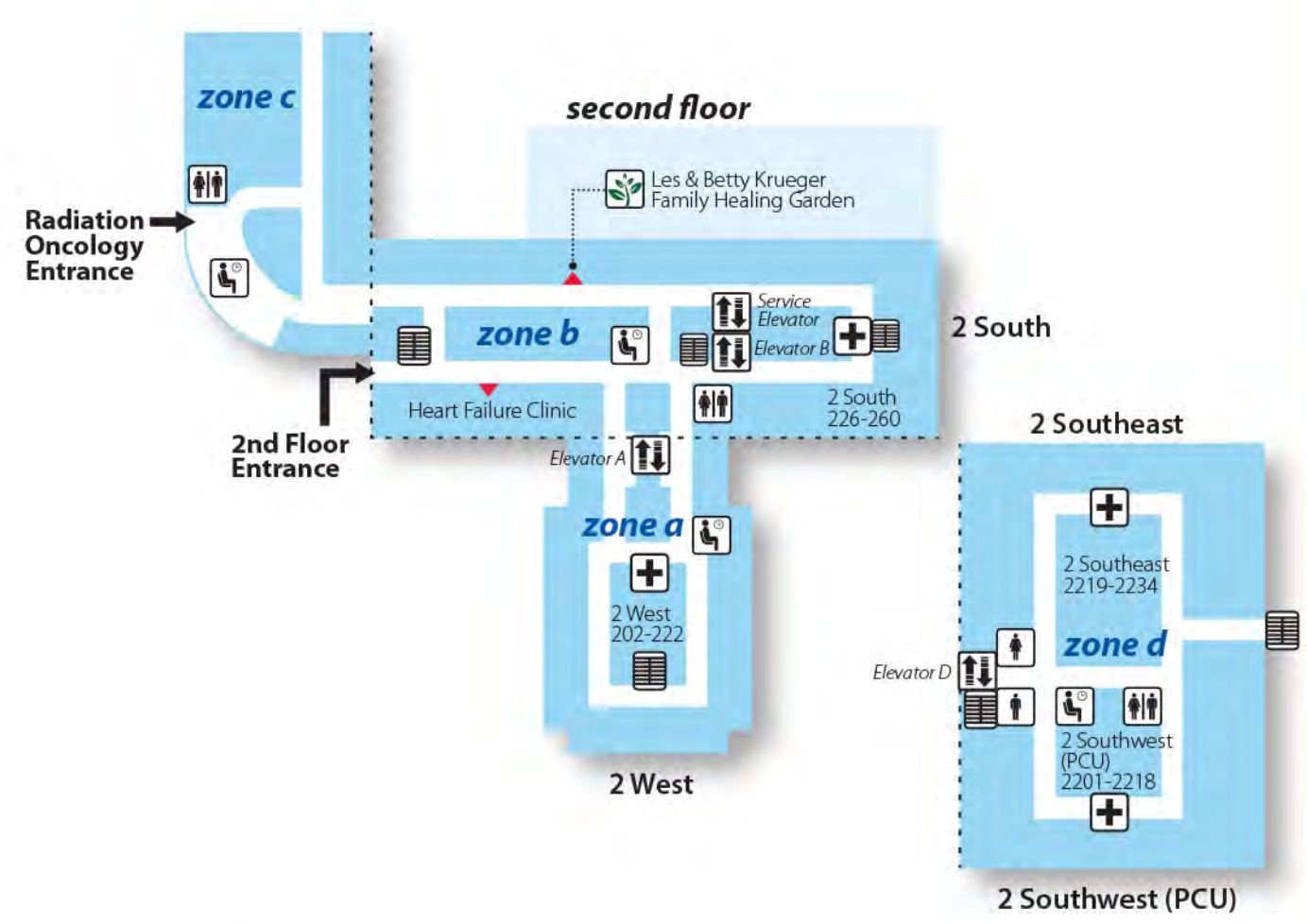
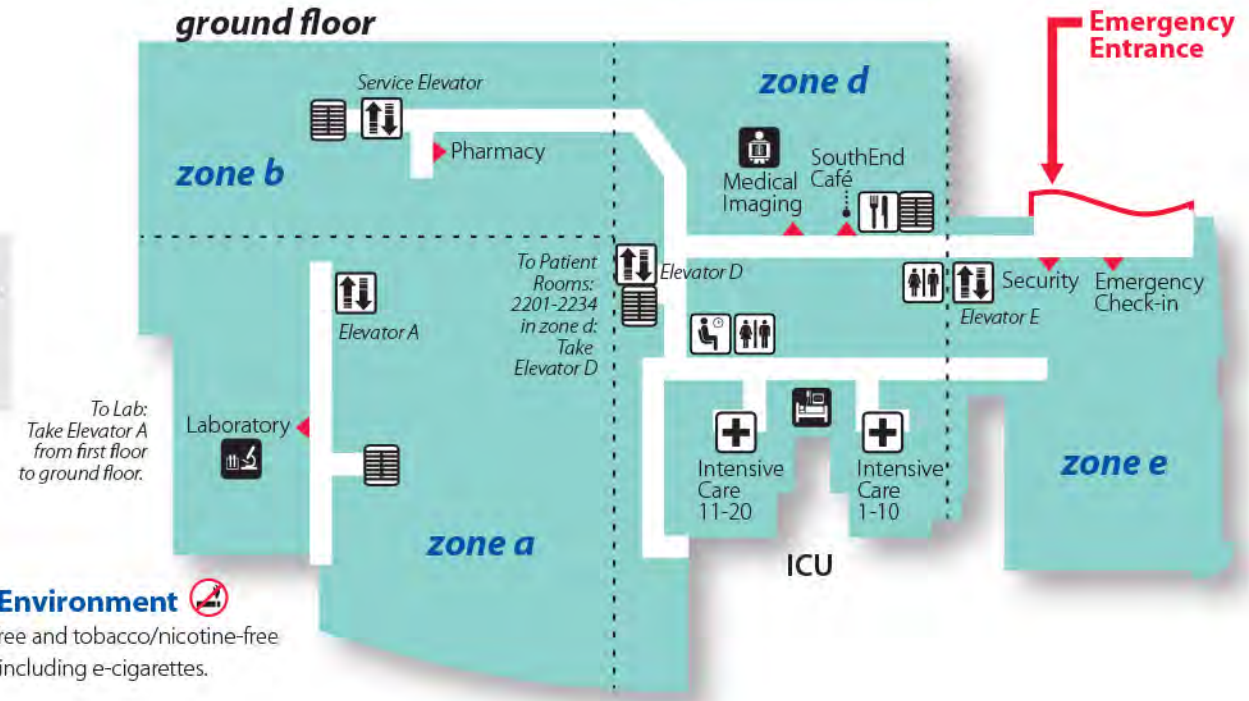

Departments and Services Directory

Department/Service	Floor	Zone
Administration	1	d
Auditorium	1	a
Cashier	1	a
Chapel	1	a
Elevators		
Elevator A	G, 1, 2, 3, 4	a
Elevator B	1, 2, 3	b
Elevator D	G, 1, 2	d
Elevator E	G	e
Emergency Check-in & Information	G	e
Food		
Cherry Ave. Eatery	1	b
Cherry St. Espresso	1	a
SouthEnd Café	G	d
Garden	1	a
Garden (Les & Betty Krueger Family Healing Garden)	2	b
Gift Shop	1	a
Heart & Vascular Center	1	d
Heart Failure Clinic	2	b
Health Information Management/Medical Records	1	b
Imaging Center	1	c
Information & Reception	1	a
Laboratory	G	a
Medical Imaging	G	d
Patient Rooms		
1-20, ICU	G	d
202-222, 2 West	2	a
2201-2218, 2 Southwest PCU	2	d
2219-2234, 2 Southeast	2	d
226-260, 2 South	2	b
302-322, 3 West	3	a
366-398, 3 North	3	b
402-422, 4 West	4	a
Pharmacy	G	b
Radiation Oncology	2	c
Security	1	b
Sleep Disorders Center	3	b
Volunteer Resources	1	d